

# SARU - Repeater Unit

## Installation and Operating Instructions

**These instructions should be read in conjunction with your system Installation and Operating Manual and retained for future reference.**

### Introduction

The SARU Repeater Unit is designed to increase the radio range of your alarm system, by receiving the signal from a distant transmitter (eg. Detector or Remote Control, etc.) and re-transmitting the signal on to your receiver (eg. Control Unit, Solar Siren, etc.). The Repeater is suitable for use with all Response 433MHz, 8 dip switch House Code, Part Wired, Wireless and Wirefree alarm systems. Ideally, the Repeater Unit should be installed mid-way between the distant detector and the receiver. The Repeater Unit requires a local, permanent 13 Amp power supply, and has provision for a back-up battery.

### Installation and Operation

**IMPORTANT:** DO NOT fix the Repeater Unit to metalwork or locate the unit within 1m of metalwork (ie. radiators, water pipes, etc.) as this could affect the radio range of the unit. The Repeater Unit and power supply are not weatherproof and must be installed indoors.

1. Using a coin, carefully lever off the front cover of the Repeater Unit.
2. Set the House Code miniature dip switches 1 - 8 to the same combination of 'ON' and 'OFF' as the dip switches in the other items in your system.
3. Connect the 12 Volt DC mains adaptor cable to the Terminal Block. Note that the striped lead is the positive (+), and the plain lead is the negative (-).

4. Fix the Repeater Unit in place using the double sided adhesive pad or screws supplied.

Extend the telescopic aerial for maximum radio range.

5. Connect the mains adaptor to the power supply and switch on. The red LED will illuminate to indicate the unit is energised.

6. **Back-up Battery.** The Repeater Unit has provision for an optional 8.4 Volt NiCad Rechargeable Battery, which will run the Repeater Unit for approx. 4 hours in the event of a mains failure. The battery will be automatically recharged on restoration of the power supply.

**IMPORTANT: DO NOT** install a standard, non rechargeable battery in the unit. If you have purchased the optional Back-up Battery fit it to the battery connector.

7. Refit the Repeater Unit front cover.
8. Test the system by arming and then triggering the distant transmitter.

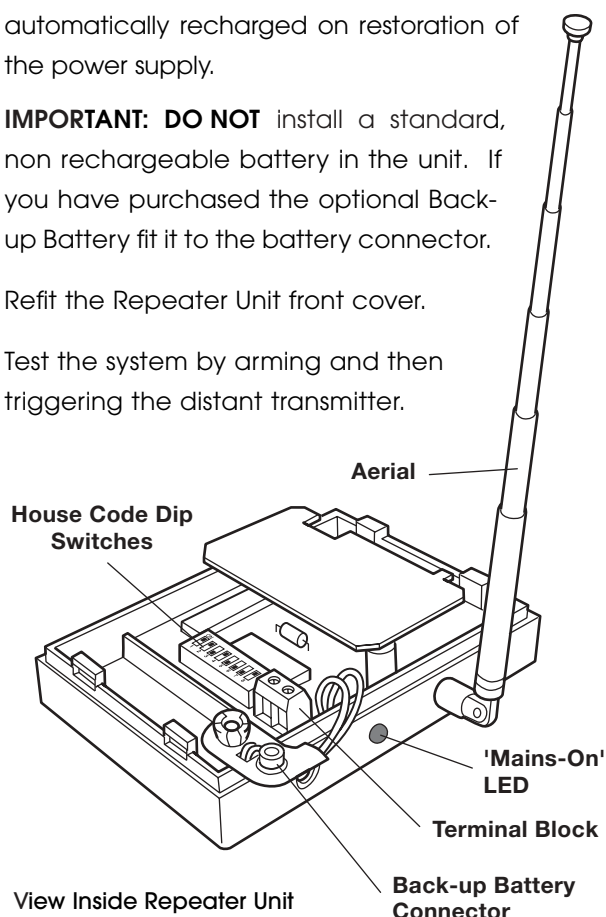

**IF YOU HAVE ANY PROBLEMS RING  
THE HELPLINE - LOCAL RATE CALL:**

**0845 373 1353**

*We can solve most problems quickly over the phone.*